

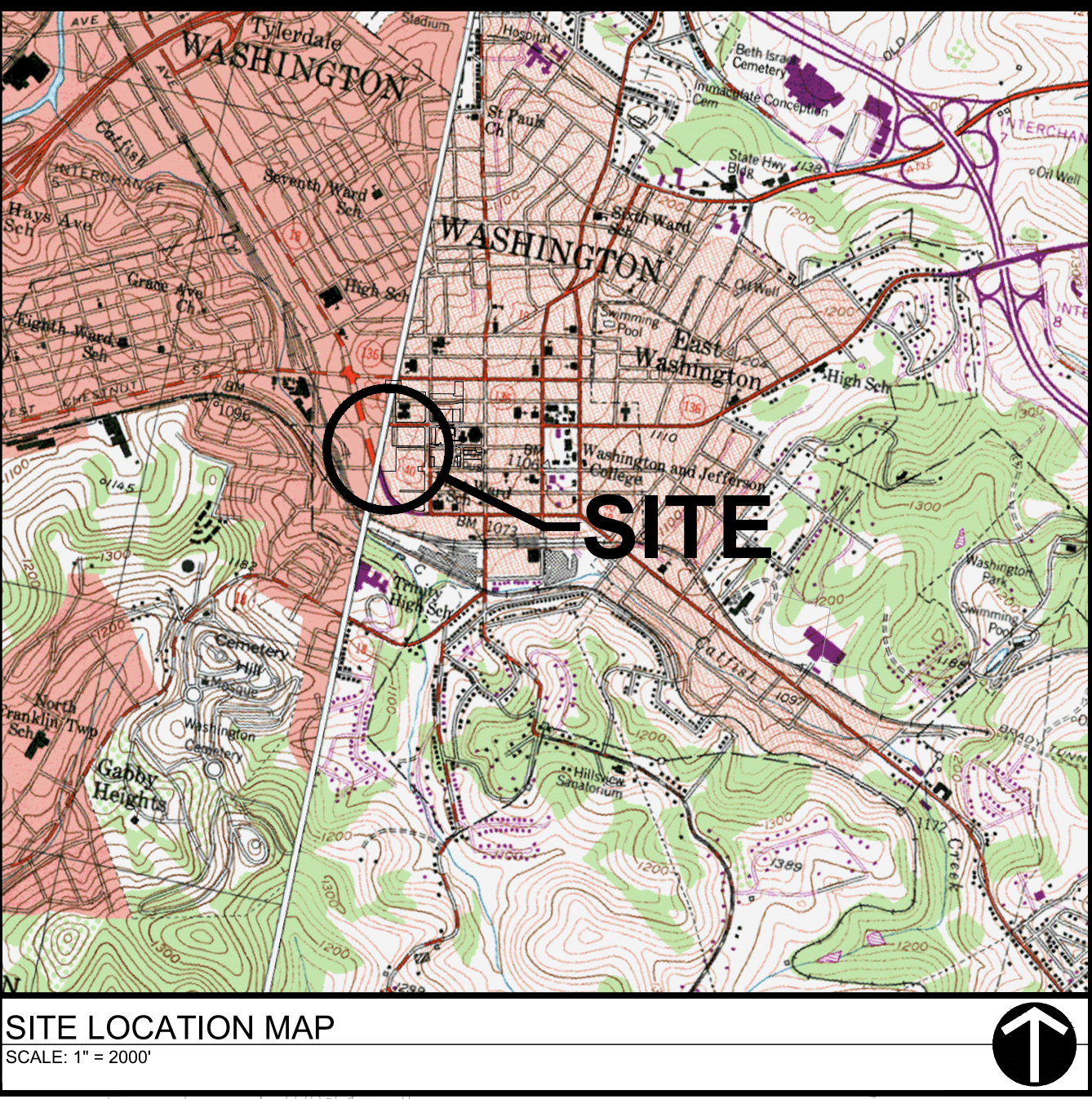

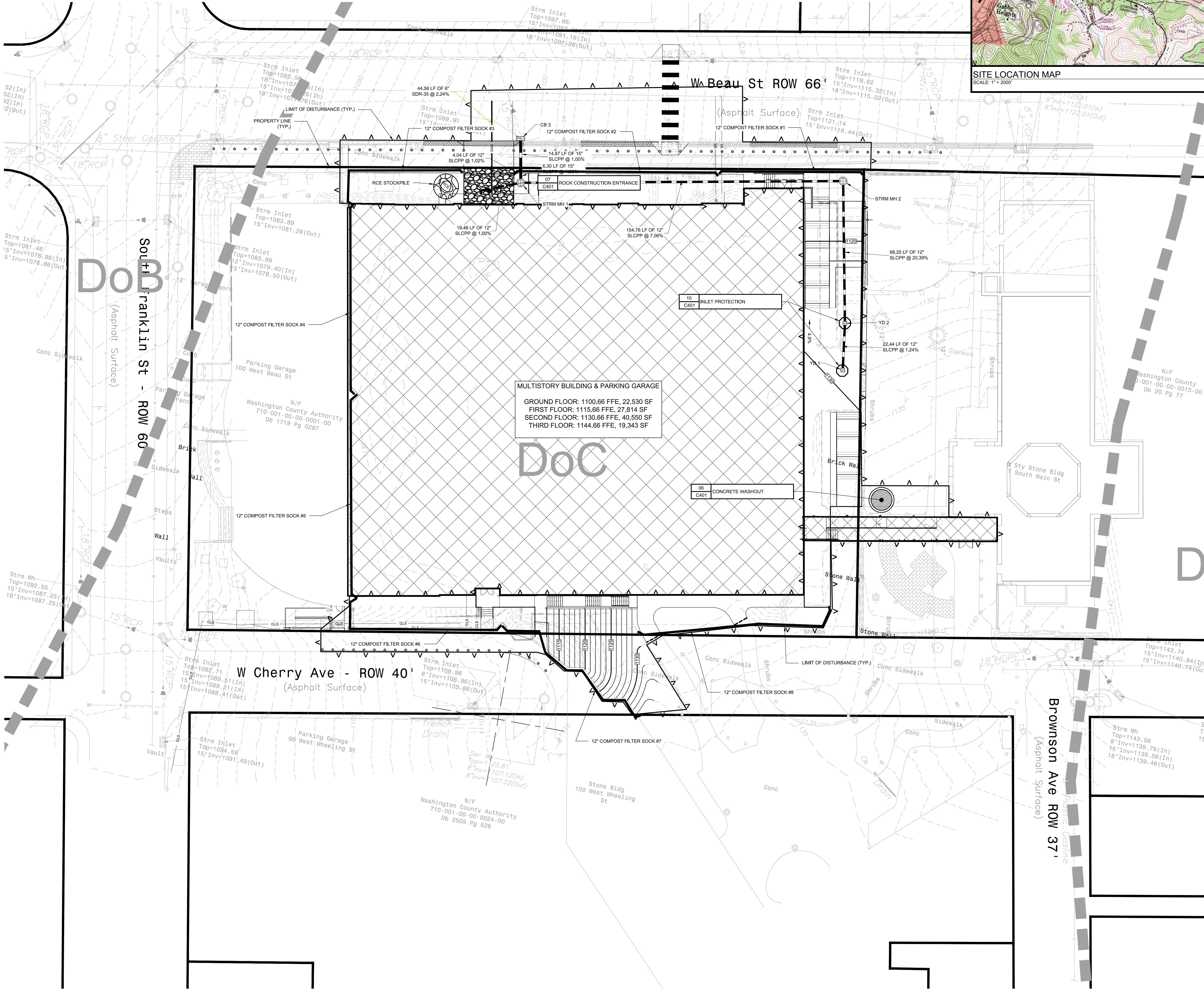

H  
G  
F  
E  
D  
C  
B  
A

THIS PLAN IS FOR EROSION AND SEDIMENT CONTROL PURPOSES ONLY



EROSION AND SEDIMENT CONTROL LEGEND	
	07 C401 ROCK CONSTRUCTION ENTRANCE
	10 C401 FILTER BAG INLET PROTECTION
	SOIL BOUNDARIES
	LIMITS OF DISTURBANCE
	PERMIT BOUNDARY
	COMPOST FILTER SOCK
	TREE PROTECTION FENCING

EROSION AND SEDIMENT CONTROL NOTES:

1. THE CONTRACTOR SHALL COMPLY AT ALL TIMES WITH APPLICABLE FEDERAL, STATE AND LOCAL LAWS, PROVISIONS, AND POLICIES GOVERNING SAFETY AND HEALTH, INCLUDING THE FEDERAL CONSTRUCTION SAFETY ACT (PUBLIC LAW 91-59), FEDERAL REGISTER, CHAPTER XVI, PART 1005 OF TITLE 29 REGULATIONS, OCCUPATIONAL SAFETY AND HEALTH REGULATIONS FOR CONSTRUCTION, AND SUBSEQUENT PUBLICATIONS UPDATING THESE REGULATIONS.
2. THE CONTRACTOR SHALL BE RESPONSIBLE FOR EXAMINING THE AREAS AND CONDITIONS UNDER WHICH THE PROJECT IS TO BE CONSTRUCTED PRIOR TO THE SUBMISSION OF THE BID. SUBMISSION OF A BID SHALL BE CONSTRUED TO MEAN THE CONTRACTOR HAS REVIEWED THE SITE AND IS FAMILIAR WITH CONDITIONS AND CONSTRAINTS OF THE SITE.
3. BEFORE EXCAVATION, ALL UNDERGROUND UTILITIES SHALL BE LOCATED IN THE FIELD BY THE PROPER AUTHORITIES. THE CONTRACTOR SHALL NOTIFY PENNSYLVANIA ONE CALL SYSTEMS, INC. AT 1-800-242-1776. THE LOCATION OF ALL UTILITIES AND UNDERGROUND STRUCTURES ARE APPROXIMATE AND MAY NOT ALL BE SHOWN. IT IS THE RESPONSIBILITY OF THE CONTRACTOR TO DETERMINE THE EXISTENCE AND EXACT LOCATION OF ALL UTILITIES AND UNDERGROUND STRUCTURES.
4. CONTRACTOR TO PROVIDE SHOP DRAWINGS ON ALL STORM SEWER MANHOLES, INLETS, AND DETENTION SYSTEMS.
5. AN AS-BUILT DRAWING OF NEW UTILITY SERVICES SHALL BE PREPARED BY THE CONTRACTOR AND SUBMITTED TO THE OWNER UPON COMPLETION OF THE PROJECT.
6. ALL STORM PIPE SHALL BE HDPE, SMOOTH INTERIOR, CORRUGATED POLYETHYLENE PIPE UNLESS OTHERWISE NOTED. ALL STORM SEWER CONSTRUCTION MATERIALS AND METHODS SHALL BE IN ACCORDANCE WITH PENNDOT SPECIFICATIONS. ALL JOINTS SHALL BE WATER-TIGHT.
7. CONTRACTOR SHALL REFER TO OTHER PLANS WITHIN THIS CONSTRUCTION SET FOR OTHER PERTINENT INFORMATION.
8. THE CONTRACTOR SHALL ASSURE THAT THERE IS POSITIVE DRAINAGE TO THE INLETS UPON PLACEMENT OF NEW PAVEMENT.

PROJECT AREAS

TOTAL PERMIT AREA = 0.43 ACRES  
LIMIT OF DISTURBANCE AREA = 0.43 ACRES  
\*THE PROPOSED BUILDING COVERAGE AREA IS NOT INCREASING FROM THE CURRENT EXISTING CONDITIONS.



Know what's below.  
Call before you dig.  
1-800-242-1776  
Serial No. 2024350172

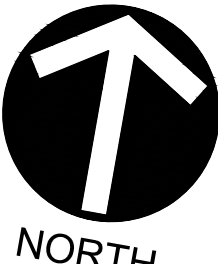

GRAPHIC SCALE

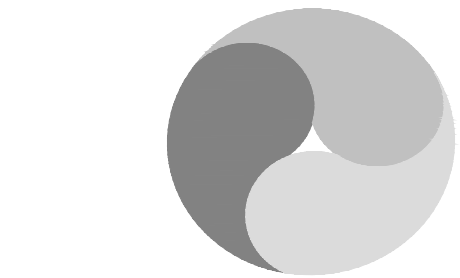
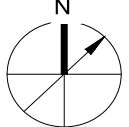
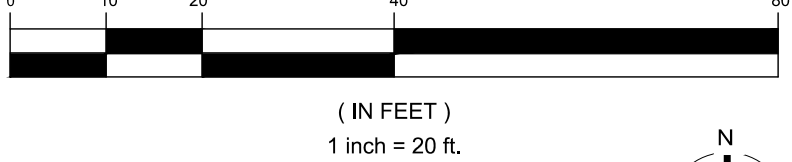

AE WORKS

418 BEAVER STREET  
SEWICKLEY, PA 15143  
PH: 412.287.7333  
www.aeworks.com

NO	DATE	REVISION

CLIENT:  
WASHINGTON COUNTY  
BOARD OF COMMISSIONERS  
95 WEST BEAU ST., SUITE 605  
WASHINGTON PA 15301

SUBMISSION:  
LAND DEVELOPMENT

NOT FOR CONSTRUCTION

PROFESSIONAL:

PROJECT NAME:  
WASHINGTON COUNTY  
PUBLIC SAFETY BUILDING

DRAWING TITLE:  
EROSION AND SEDIMENT  
CONTROL PLAN

DRAWN BY: MBM  
CHECKED BY: SMD  
PROJ. NO.: WASH-001  
DATE: 8/1/2025  
DRAWING NO.:

C400

COPYRIGHT 2025 BY AE WORKS LTD ALL RIGHTS RESERVED.



